

SSMA

INTERFACE MATING DIMENSIONS:

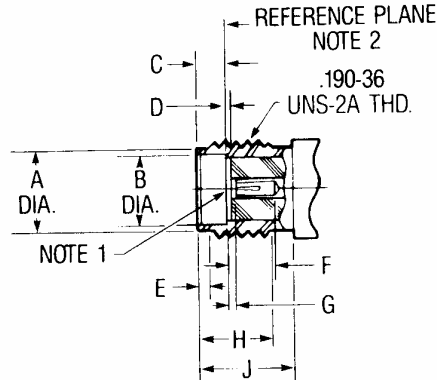
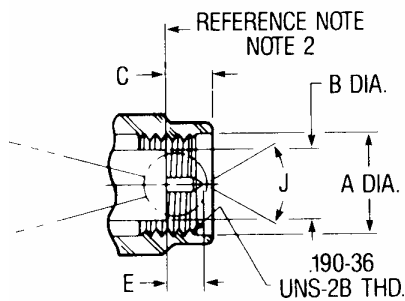

PLUG		
Letter	Inches (Millimeters) ³	
	Minimum	Maximum
A	.196 (4.98)	.202 (5.13)
B	.124 (3.15)	.1268 (3.221)
C	.100 (2.54)	.133 (3.38)
D	.000 (0.00)	.007 (0.25)
E	.050 (1.27)	.065 (1.65)
F	.000 (0.00)	.010 (0.25)
G	.0195 (0.495)	.0208 (0.528)
H	.000 (0.00)	.010 (0.25)
J	70°	95°

JACK		
Letter	Inches (Millimeters) ³	
	Minimum	Maximum
A	.153 (3.89)	.160 (4.06)
B	.127 (3.23)	.130 (3.30)
C	.075 (1.91)	.077 (1.96)
D	.000 (0.00)	.007 (0.25)
E	.020 (0.51)	.040 (1.02)
F	.075 (1.91)	-
G	.000 (0.00)	.010 (.025)
H	.190 (4.83)	.210 (5.33)
J	.203 (5.84)	-

Electrical:

Impedance	50 ohm
Frequency Range	<ul style="list-style-type: none"> for RG - 405 semi-rigid cable – 0 to 40.0 GHz for flexible cable → max operation frequency to 0 – 26 GHz
VSWR	1.3 max 0 – 26 GHz 1.6 max 26 – 40 GHz
Dielectric Withstanding Voltage	RG 405 (.085" OD.) → 750 volts rms max RG – 174, 188, 316 → 750 volts rms max RG – 178, 196 → 500 volts rms max
Contact Resistance	center contact = 2.0 Milliohms max outer contact = 2.0 milliohms max
RF Leakage	-(90 – f GHz) db min
Insertion Loss	.04 dB maximum X √f GHz (straight) .06 dB maximum X √f GHz (right angle)
Insulation Resistance	5,000 Megohms min

Mechanical & Environmental:

Mating	10 – 36 threaded coupling
Durability	500 matings
Coupling Nut Retention	Min 60 lbs
Recommend Nut Mating Torque	7 to 8 in-lbs
Temperature Range	-65 °C to 155 °C
Vibration	MIL-STD-202 Method 204 Test Cond. D.
Salt Spray	MIL-STD-202 Method 101 Test Cond. B.
Temperature Cycling	MIL-STD-202 Method 102 Test Cond. D.

Material:

	Material	Plating
Connector Body	Stainless steel Type 303 Beryllium Copper	Passivated or gold Nickel or gold
Center Contact	Male: Brass Female: Beryllium Copper	Gold
Insulation	Teflon	None
Gasket	Silicon Rubber	None
Crimp Ferrule	Annealed Copper	Same as Body

Staright Plug (SSMA)

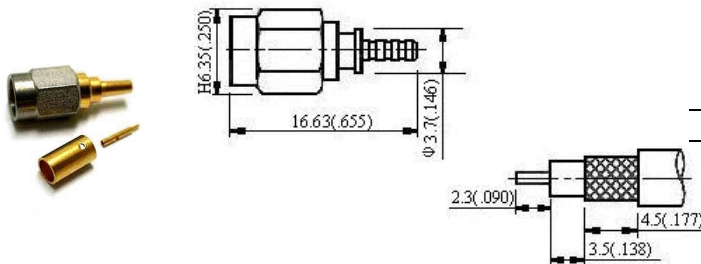

PART NO.	APPLICABLE CABLE RG/U
SSMA-1101-TGG	178, 196
SSMA-1102-TGG	174, 188, 316

Description:
For Flexible Cable

Finish: Gold plated center contact & body
Insulation: Teflon

Right Angle Plug (SSMA)

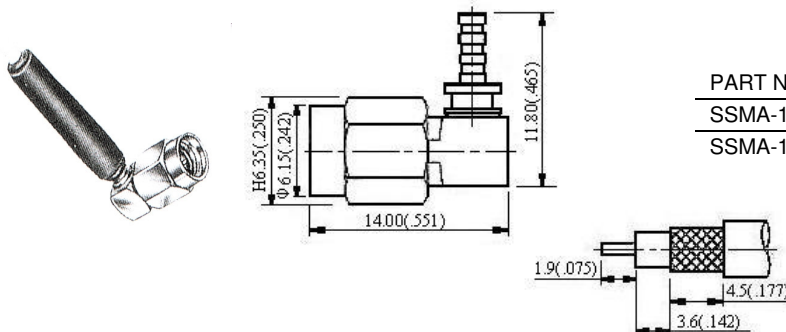

PART NO.	APPLICABLE CABLE RG/U
SSMA-1105-TGG	178, 196
SSMA-1106-TGG	174, 188, 316

Description:
For Flexible Cable

Finish: Gold plated center contact & body
Insulation: Teflon

Staright Jack (SSMA)

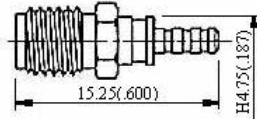

PART NO.	APPLICABLE CABLE RG/U
SSMA-1203-TGG	178, 196
SSMA-1204-TGG	174, 188, 316

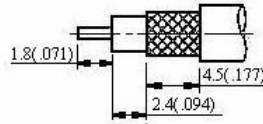

Description:
For Flexible Cable

Finish: Gold plated center contact & body
Insulation: Teflon

Flange Mount Jack Receptacle (SSMA)

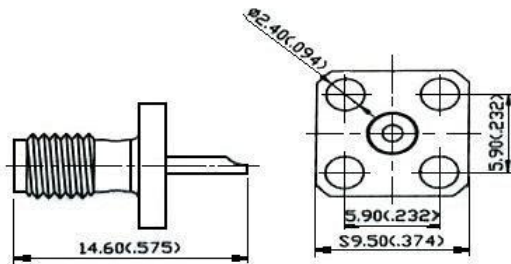

PART NO.
SSMA-3201-TGG

Description:
Panel Mount Receptacle

Finish: Gold plated center contact & body
Insulation: Teflon

Flange Mount Jack Receptacle (SSMA)

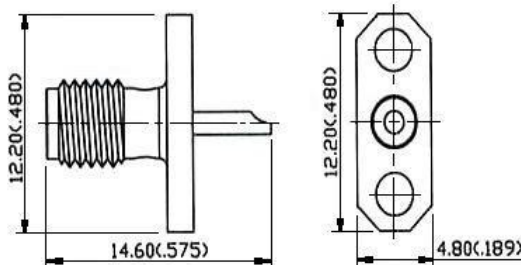

PART NO.
SSMA-3202-TGG

Description:
Panel Mount Receptacle

Finish: Gold plated center contact & body
Insulation: Teflon

Bulkhead Feedthrough Jack Receptacle (SSMA)

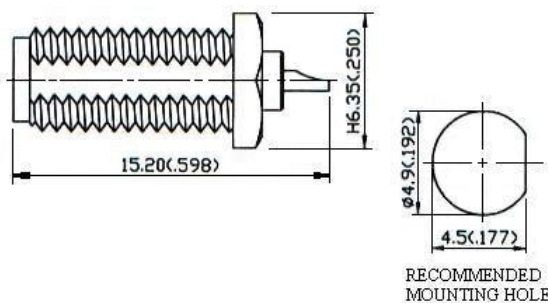
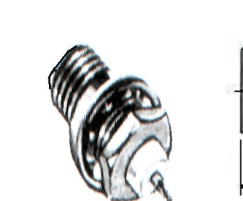

PART NO.
SSMA-4201-TGG

Description:
Bulkhead Mount Receptacle

Finish: Gold plated center contact & body
Insulation: Teflon

Bulkhead Feedthrough Jack Receptacle (SSMA)

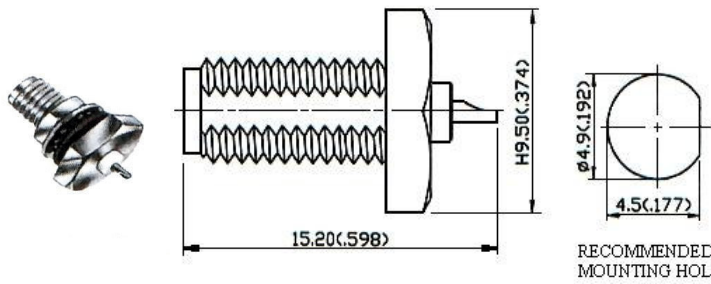

PART NO.
SSMA-4202-TGG

Description:
Bulkhead Mount Receptacle

Finish: Gold plated center contact & body
Insulation: Teflon

Bulkhead Feedthrough Jack Receptacle (SSMA)

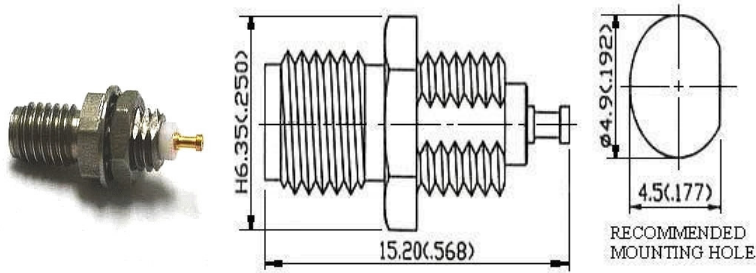

PART NO.
SSMA-4203-TGG

Description:
Bulkhead Mount Receptacle

Finish: Gold plated center contact & body
Insulation: Teflon

Staright Jack (SSMA)

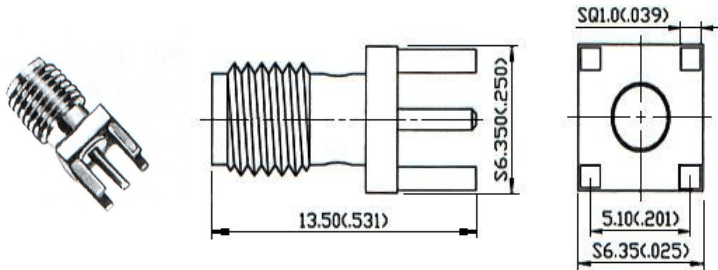

PART NO.
SSMA-5201-TGG

Description:
Printed Circuit Boards

Finish: Gold plated center contact & body
Insulation: Teflon

Right Angle Jack (SSMA)

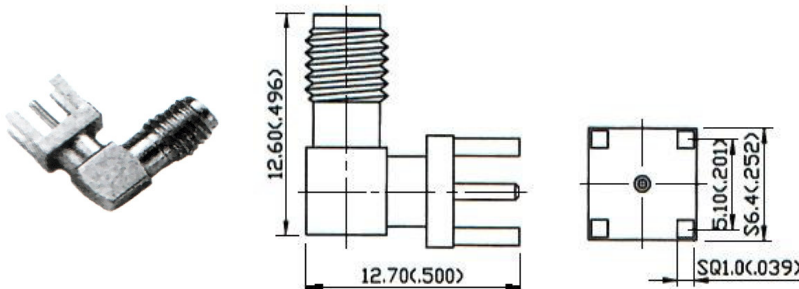

PART NO.
SSMA-5202-TGG

Description:
Printed Circuit Boards

Finish: Gold plated center contact & body
Insulation: Teflon

Jack to Jack (SSMA)

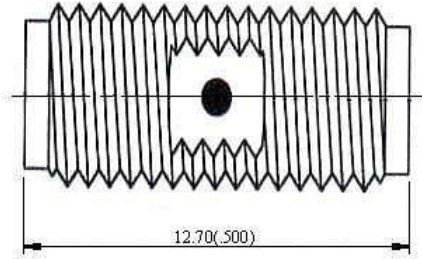

PART NO.
SSMA-601-TGG

Description:
In-Series Adapters

Finish: Gold plated center contact & body
Insulation: Teflon

Plug to Plug (SSMA)

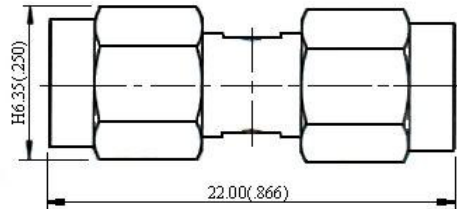

PART NO.
SSMA-602-TGG

Description:
In-Series Adapters

Finish: Gold plated center contact & body
Insulation: Teflon

Straight Plug With Center Contact (SSMA)

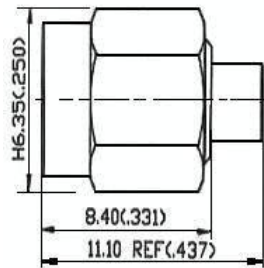

PART NO.	APPLICABLE CABLE RG/U
SSMA-7101-TGG	RG 405/u (.085")

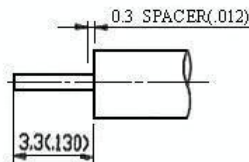

Description:
For Semi-Rigid Cable

Finish: Gold plated center contact & body
Insulation: Teflon

Right Angle Plug (SSMA)

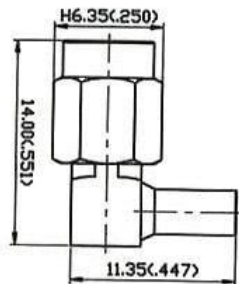

PART NO.	APPLICABLE CABLE RG/U
SSMA-7105-TGG	RG 405/u (.085")

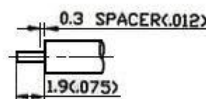

Description:
For Semi-Rigid Cable

Finish: Gold plated center contact & body
Insulation: Teflon

Straight Jack With Center Contact (SSMA)

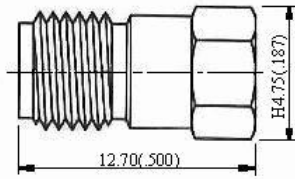

PART NO.	APPLICABLE CABLE RG/U
SSMA-7202-TGG	RG 405/u (.085")

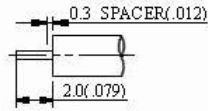

Description:
For Semi-Rigid Cable

Finish: Gold plated center contact & body
Insulation: Teflon

Bulkhead Feedthrough Jack (SSMA)

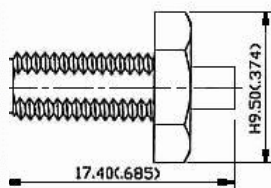

PART NO.	APPLICABLE CABLE RG/U
SSMA-7203-TGG	RG 405/u (.085")

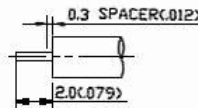
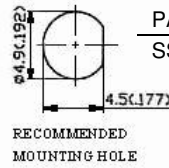

Description:
For Semi-Rigid Cable

Finish: Gold plated center contact & body
Insulation: Teflon

Flange Mount Jack (SSMA)

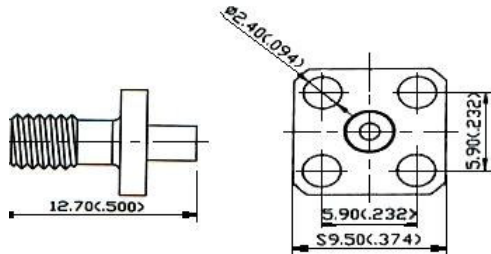
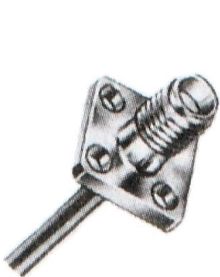

PART NO.	APPLICABLE CABLE RG/U
SSMA-7204-TGG	RG 405/u (.085")

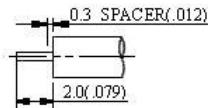

Description:
For Semi-Rigid Cable

Finish: Gold plated center contact & body
Insulation: Teflon