

MCX

50 ohm 0 – 6 GHz

MCX microminiature connectors provide repeatable performance from DC to 6 GHz. The design of these devices have taken into consideration the need for size reduction, low weight, durability and reliable performance. The MCX devices enable a 30% space reduction over similar SMB/SMC types. The MCX is available for affixment to industry standard cable and as a printed circuit board device. The “snap-on” connection feature between devices offer the user ease of assembly in dense packaging layouts. Applications for the MCX are those where size, Weight, performance and ease of assembly are the driving considerations to the final design decision. Typically, these include GPS, wireless communications (WLAN and mobile) and automotive.

INTERFACE DIMENSIONS:

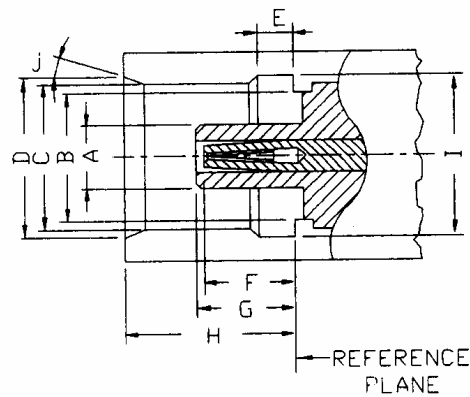
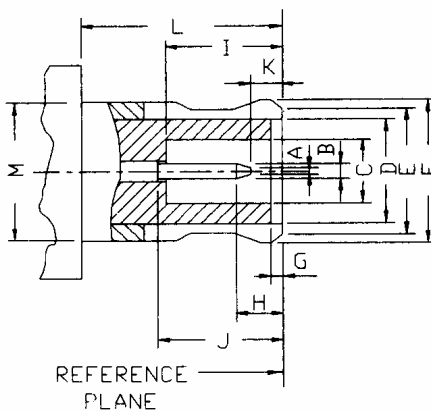

PLUG		
Letter	Millimeters (Inches)	
	Minimum	Maximum
A	-	0.25 (.010)
B	0.48 (.019)	0.53 (.021)
C	2.00 (.079)	2.07 (.0815)
D	-	3.00 (.118)
E	-	3.60 (.142)
F	3.63 (.143)	3.80 (.150)
G	0.00 (.000)	0.30 (.012)
H	-	1.20 (.047)
I	2.80 (.110)	3.20 (.126)
J	2.80 (.110)	3.20 (.126)
K	0.15 (.006)	-
L	4.15 (.163)	-
M	-	3.40 (.134)

JACK		
Letter	Millimeters (Inches)	
	Minimum	Maximum
A	1.80 (.079)	1.98 (.078)
B	-	3.00 (.118)
C	3.42 (.135)	3.48 (.137)
D	3.80 (.150)	-
E	0.75 (.029)	0.85 (.033)
F	2.30 (.090)	2.80 (.110)
G	2.60 (.102)	2.80 (.110)
H	4.00 (.157)	4.12 (.162)
I	3.60 (.142)	3.80 (.150)
J	18°	22°

Electrical:

Impedance	50 ohm
Frequency Range	0 to 6.0 GHz
VSWR	0 – 2 GHz = 1.22 max (straight) 1.50 max (right angle) 2 – 6 GHz = 1.35 max (straight) 1.63 max (right angle)
Dielectric Withstanding Voltage	RG – 174, 188, 316 → 750 volts rms max RG – 178, 196 → 500 volts rms max
Contact Resistance	center contact = 5.0 Milliohms max outer contact = 2.5 milliohms max
RF Leakage	-60 dB min
Insertion Loss	.4 dB max (straight) .6 dB max (right angle)
Insulation Resistance	1,000 Megohms min

Mechanical & Environmental:

Mating	“Push-pull” snap-on coupling
Durability	500 matings
Cable Retention	RG – 174, 188, 316 → 20 lbs min
Temperature Range	-65 °C to 165 C°
Vibration	MIL-STD-202 Method 204 Test Cond. B.
Salt Spray	MIL-STD-202 Method 101 Test Cond. B.
Temperature Cycling	MIL-STD-1344 Method 1003 Test Cond. A.

Material:

	Material	Plating
Connector Body	Brass	Nickel or Gold
Center Contact	Male: Brass Female: Beryllium Copper	Gold
Insulation	Teflon	None
Crimp Ferrule	Annealed Copper	Same as Body

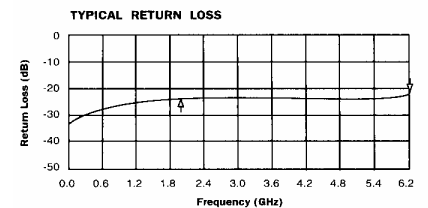

Straight Plug Crimp (MCX)

PART NO.	APPLICABLE CABLE RG/U
MCX-1101-TGG	174, 188A, 316
MCX-1102-TGG	178, 196

Description:
Flexible Cable-Crimp Attachment

Finish: Gold plated center contact & body
Insulation: Teflon

Right Angle Plug Crimp (MCX)

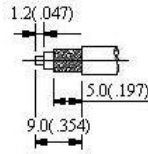
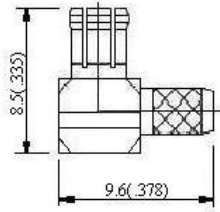

PART NO.	APPLICABLE CABLE RG/U
MCX-1105-TGG	174, 188A, 316
MCX-1106-TGG	178, 196

Description:
Flexible Cable-Crimp Attachment

Finish: Gold plated center contact & body
Insulation: Teflon

Straight Jack Crimp (MCX)

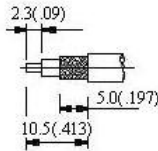
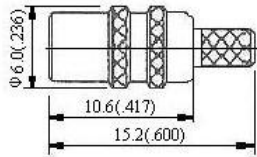
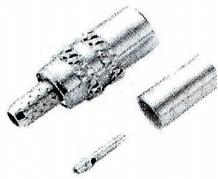

PART NO.	APPLICABLE CABLE RG/U
MCX-1203-TGG	174, 188A, 316
MCX-1204-TGG	178, 196

Description:
Flexible Cable-Crimp Attachment

Finish: Gold plated center contact & body
Insulation: Teflon

Straight Bulkhead Jack Crimp (MCX)

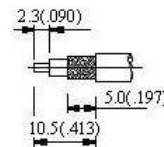
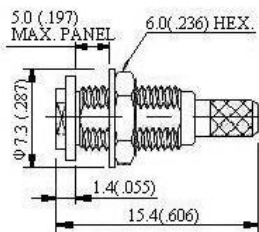

PART NO.	APPLICABLE CABLE RG/U
MCX-1207-TGG	174, 188A, 316
MCX-1208-TGG	178, 196

Description:
Flexible Cable-Crimp Attachment

Finish: Gold plated center contact & body
Insulation: Teflon

2 Holes Flange Jack Receptacle (Exposed Teflon) (MCX)

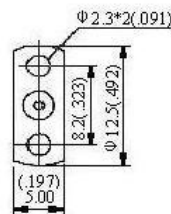
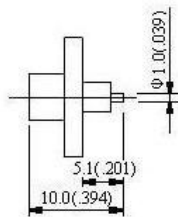

PART NO.
MCX-3201-TGG

Description:
Panel Mount Receptacle

Finish: Gold plated center contact & body
Insulation: Teflon

2 Holes Flange Jack Receptacle (Solder Pot Contact) (MCX)

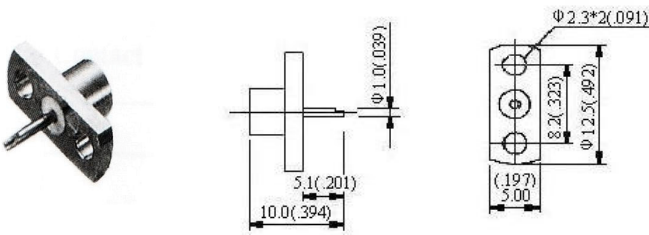

PART NO. _____
MCX-3202-TGG

Description:
Panel Mount Receptacle

Finish: Gold plated center contact & body
Insulation: Teflon

PCB Cable Terminal-Crimp Type (MCX)

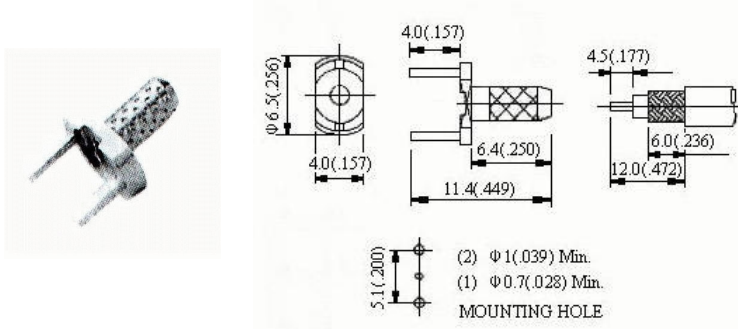

PART NO. _____
MCX-5004-G

Description:
Printed Circuit Board Receptacles

Finish: Gold plated

Straight PCB Mount Bulkhead Jack Receptacle (MCX)

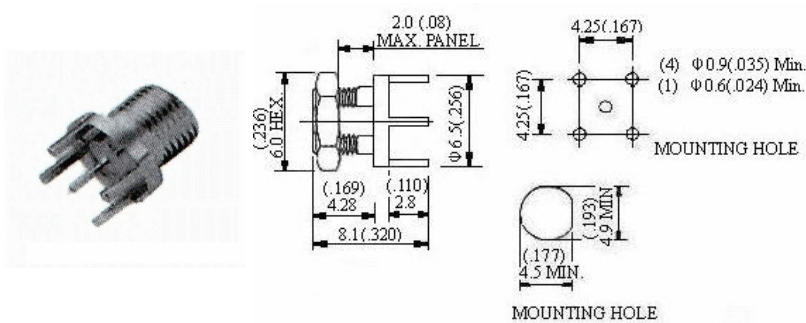

PART NO. _____
MCX-5201-TGG

Description:
Printed Circuit Board Receptacles

Finish: Gold plated center contact & body
Insulation: Teflon

Straight PCB Mount Jack Receptacle (MCX)

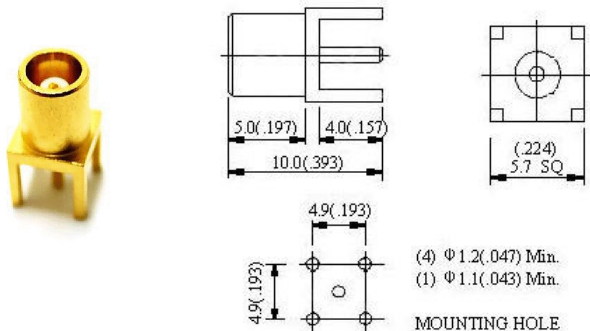

PART NO. _____
MCX-5202-TGG

Description:
Printed Circuit Board Receptacles

Finish: Gold plated center contact & body
Insulation: Teflon

Right Angle PCB Mount Jack Receptacle (MCX)

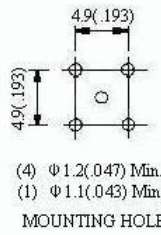
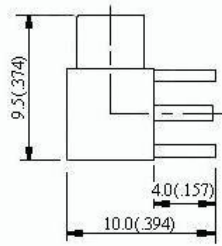
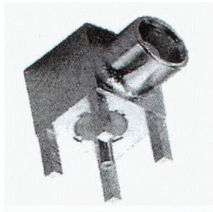

PART NO.
MCX-5203-TGG

Description:
Printed Circuit Board Receptacles

Finish: Gold plated center contact & body
Insulation: Teflon

Straight Surface Mount Jack Receptacle (MCX)

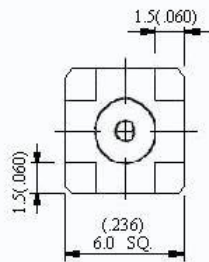
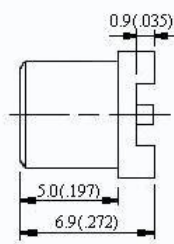
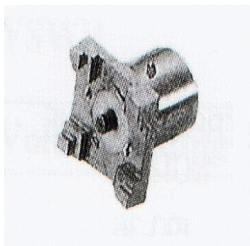

PART NO.
MCX-5205-TGG

Description:
Surface Mount Receptacle

Finish: Gold plated center contact & body
Insulation: Teflon

Right Angle Surface Mount Jack Receptacle (MCX)

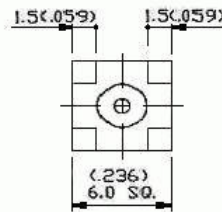
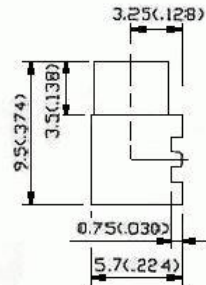
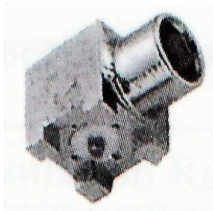

PART NO.
MCX-5206-TGG

Description:
Surface Mount Receptacle

Finish: Gold plated center contact & body
Insulation: Teflon

PCB Cable Terminal (MCX)

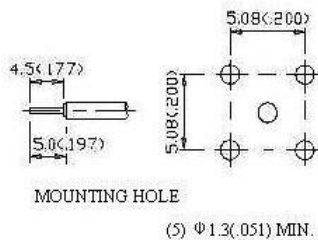
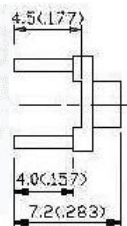
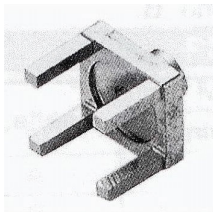

PART NO. MCX-7003-G	APPLICABLE CABLE RG/U RG405/u(.085")
------------------------	---

Description:
For Semi-Rigid Cable
(.085" Direct Solder Attachment)

Finish: Gold plated
Insulation: Teflon

PCB Cable Terminal (MCX)

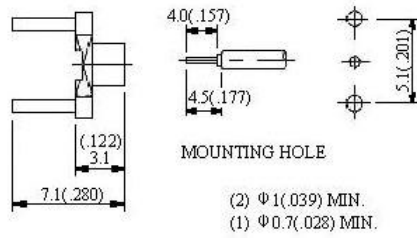
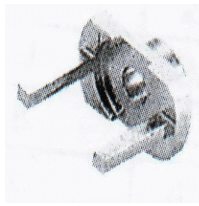

PART NO.	APPLICABLE CABLE RG/U
MCX-7004-G	RG405/u(.085")

Description:
For Semi-Rigid Cable
(.085" Direct Solder Attachment)

Finish: Gold plated

Straight Plug (MCX)

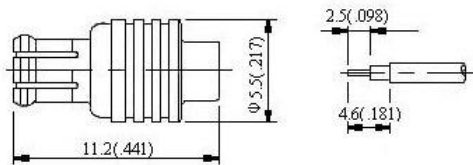

PART NO.	APPLICABLE CABLE RG/U
MCX-7101-TGG	RG405/u(.085")

Description:
For Semi-Rigid Cable
(.085" Direct Solder Attachment)

Finish: Gold plated center contact & body
Insulation: Teflon

Straight Angle Plug (MCX)

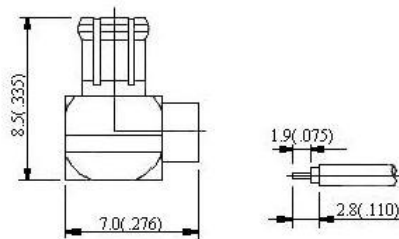

PART NO.	APPLICABLE CABLE RG/U
MCX-7102-TGG	RG405/u(.085")

Description:
For Semi-Rigid Cable
(.085" Direct Solder Attachment)

Finish: Gold plated center contact & body
Insulation: Teflon